



Sony Centre, Berlin

## GEZE TS 1000 C

Surface-mounted rack and pinion door closer

# Surface-mounted rack and pinion door closer



### Product features

- ▶ Variable closing force in two sizes achieved by simply turning the link arm's power shoe:
  - 'Weak' for leaf widths up to 850 mm (closing force size 2 to EN 1154)
  - 'Strong' for leaf widths up to 950 mm (closing force size 3 to EN 1154)
- ▶ Increased closing force due to offset installation for leaf widths up to 1100 mm (closing force size 4 to EN 1154)
- ▶ Closing speed and latching action adjustable
- ▶ Option: with hold-open link arm allowing the closer to hold doors open between 70° and 150°

### Specifications

Overhead rack and pinion door closer GEZE TS 1000 C with adjustable closing speed and adjustable latching action, also available with mounting plate.

#### Finish:

- ( ) silver
- ( ) dark bronze
- ( ) white
- ( ) black
- ( ) brass colored
- ( ) RAL ...

### Application range

- ▶ For single-action doors up to 950 mm (1100 mm)
- ▶ Can be used for right and left hand doors without adjustment
- ▶ For all common types of installation

Dimensions EN size 2/3

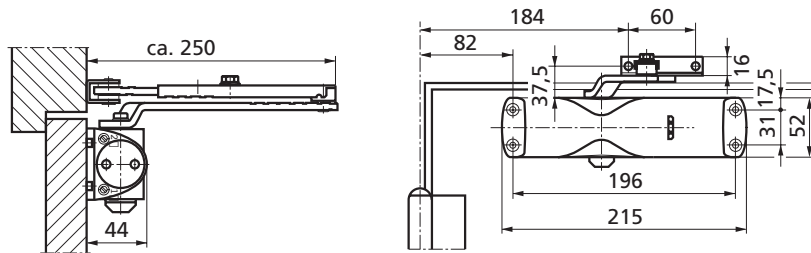

Dimensions EN size 4 max. opening angle approx. 110°

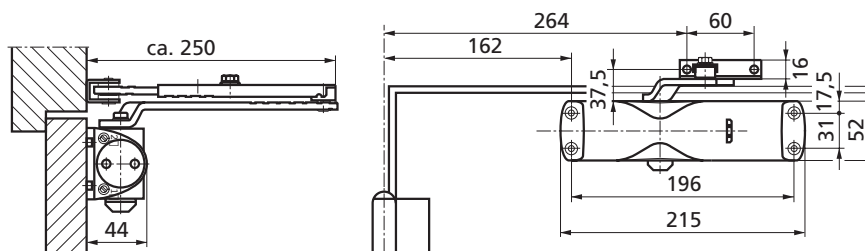

**Standard version/package**

Overhead door closer GEZE TS 1000 C complete with link arm, screw accessories and installation template (Mounting plate not included)

**Models**

- ▶ GEZE TS 1000 C Standard version
- ▶ GEZE TS 1000 C with hold-open link arm for an adjustable opening angle between 70° and 150°



**GEZE TS 1000 C – Ordering text**

Description	Colour	ID No.
GEZE TS 1000 C with standard link arm	silver	101765
	dark bronze	101766
	white RAL 9016	101767
	black RAL 9005	101678
	brass coloured	101770
	RAL colour	101769
GEZE TS 1000 C with hold-open link arm	silver	101771
	dark bronze	101772
	white RAL 9016	101773
	black RAL 9005	101774
	brass coloured	101777
	RAL colour	101776
Mounting plate for doors where direct mounting is not possible	silver	072019
	dark bronze	072020
	white RAL 9016	072021
	black RAL 9005	072022

**GEZE GmbH**

P.O. Box 1363  
71226 Leonberg  
Germany

**GEZE GmbH**

Reinhold-Vöster-Straße 21-29  
71229 Leonberg  
Germany  
Telefon +49 (0) 7152-203-0  
Telefax +49 (0) 7152-203-310

**GEZE Online:**

[www.geze.com](http://www.geze.com)

**GEZE Branch offices****Germany****GEZE GmbH**

Niederlassung Nord/Ost  
Bühningstraße 8  
13086 Berlin (Weissensee)  
Tel. +49 (0) 30-47 89 90-0  
Fax +49 (0) 30-47 89 90-17  
E-mail: [berlin.de@geze.com](mailto:berlin.de@geze.com)

**GEZE GmbH**

Niederlassung West  
Nordsternstraße 65  
45329 Essen  
Tel. +49 (0) 201-83082-0  
Fax +49 (0) 201-83082-20  
E-mail: [essen.de@geze.com](mailto:essen.de@geze.com)

**GEZE GmbH**

Niederlassung Mitte  
Adenauerallee 2  
61440 Oberursel (b. Frankfurt)  
Tel. +49 (0) 6171-63610-0  
Fax +49 (0) 6171-63610-1  
E-mail: [frankfurt.de@geze.com](mailto:frankfurt.de@geze.com)

**GEZE GmbH**

Niederlassung Süd  
Reinhold-Vöster-Straße 21-29  
71229 Leonberg  
Tel. +49 (0) 7152-203-594  
Fax +49 (0) 7152-203-438  
E-mail: [leonberg.de@geze.com](mailto:leonberg.de@geze.com)

**GEZE Subsidiaries****Germany**

**GEZE Sonderkonstruktionen GmbH**  
Planken 1  
97944 Boxberg-Schweigern  
Tel. +49 (0) 7930-9294-0  
Fax +49 (0) 7930-9294-10  
E-mail: [sk.de@geze.com](mailto:sk.de@geze.com)

**GEZE Service GmbH**

Reinhold-Vöster-Straße 25  
71229 Leonberg  
Tel. +49 (0) 7152-9233-0  
Fax +49 (0) 7152-9233-60  
E-mail: [info@geze-service.com](mailto:info@geze-service.com)

**GEZE Service GmbH**

Niederlassung Berlin  
Bühningstraße 8  
13086 Berlin (Weissensee)  
Tel. +49 (0) 30-470217-30  
Fax +49 (0) 30-470217-33

**Europe****Benelux****GEZE Benelux B.V.**

Leemkuil 1  
Industrieterrein Kapelbeemd  
5626 EA Eindhoven  
Tel. +31 (0) 40-26290-80  
Fax +31 (0) 40-26290-85  
E-mail: [benelux.nl@geze.com](mailto:benelux.nl@geze.com)

**France****GEZE France S.A.R.L.**

ZAC de l'Orme Rond  
RN 19  
77170 Servon  
Tel. +33 (0) 1-60626070  
Fax +33 (0) 1-60626071  
E-mail: [france.fr@geze.com](mailto:france.fr@geze.com)

**Great Britain**

**GEZE UK Ltd.**  
Blenheim Way  
Fradley Park  
Lichfield  
Staffordshire WS13 8SY  
Tel. +44 (0) 1543-443000  
Fax +44 (0) 1543-443001  
E-mail: [info@geze-uk.com](mailto:info@geze-uk.com)

**Italy****GEZE Italia Srl**

Via Giotto 4  
20040 Cambiago (MI)  
Tel. +39 02 95 06 95-11  
Fax +39 02 95 06 95-33  
E-Mail [italia.it@geze.it](mailto:italia.it@geze.it)

**GEZE Engineering Roma Srl**

Via Lucrezia Romana 91  
00178 Roma  
Tel. +39 06-7265311  
Fax +39 06-72653136  
E-mail: [gezeroma@libero.it](mailto:gezeroma@libero.it)

**GEZE Engineering Bari Srl**

Via Treviso 58  
70022 Altamura (Bari)  
Tel. +39 080-3115219  
Fax +39 080-3164561  
E-mail: [gezebari@libero.it](mailto:gezebari@libero.it)

**Austria****GEZE Austria GmbH**

Mayrwiesstraße 12  
5300 Hallwang b. Salzburg  
Tel. +43 (0) 662-663142  
Fax +43 (0) 662-663142-15  
E-mail: [austria.at@geze.com](mailto:austria.at@geze.com)

**Poland****GEZE Polska Sp. z o.o.**

ul. Annopol 3 (Zeran Park)  
03-236 Warszawa  
Tel. +48 (0) 22-8142211  
Fax +48 (0) 22-6142540  
E-mail: [geze@geze.pl](mailto:geze@geze.pl)

**Switzerland****GEZE Schweiz AG**

Bodenackerstrasse 79  
4657 Dulliken  
Tel. +41 (0) 62-285 54 00  
Fax +41 (0) 62-285 54 01  
E-mail: [schweiz.ch@geze.com](mailto:schweiz.ch@geze.com)

**Spain****GEZE Iberia S.R.L.**

Pol. Ind. El Pla  
C/ Comerc, 2-22, Nave 12  
08980 Sant Feliu de Llobregat (Barcelona)  
Tel. +34-(0) 9-02 19 40 36  
Fax +34-(0) 9-02 19 40 35  
E-mail: [iberia.es@geze.com](mailto:iberia.es@geze.com)

**Scandinavia****Sweden**

**GEZE Scandinavia AB**  
Mallslingan 10  
Box 7060  
18711 Täby  
Tel. +46 (0) 8-7323-400  
Fax +46 (0) 8-7323-499  
E-mail:  [sverige.se@geze.com](mailto: sverige.se@geze.com)

**Norway**

**GEZE Scandinavia AB avd. Norge**  
Postboks 63  
2081 Eidsvoll  
Tel. +47 (0) 639-57200  
Fax +47 (0) 639-57173  
E-mail: [norge.se@geze.com](mailto:norge.se@geze.com)

**Finland****GEZE Finland**

Branch office of GEZE Scandinavia AB  
Postbox 20  
158 71 Hollola  
Tel. +358 (0) 10-400 51 00  
Fax +358 (0) 10-400 51 20  
E-mail: [finland.se@geze.com](mailto:finland.se@geze.com)

**Denmark****GEZE Denmark**

Branch office of GEZE Scandinavia AB  
Møllehusene 3, 3. th.  
4000 Roskilde  
Tel. +45 (0) 46-323324  
Fax +45 (0) 46-323326  
E-mail:  [danmark.se@geze.com](mailto: danmark.se@geze.com)

**Middle East****U.A.E.**

**GEZE Middle East**  
P.O. Box 17903  
Jebel Ali Free Zone  
Dubai  
Tel. +971 (0) 4-8833112  
Fax +971 (0) 4-8833240  
E-mail: [geze@emirates.net.ae](mailto:geze@emirates.net.ae)

**Asia****GEZE Asia Pacific Ltd.**

Unit 630, Level 6, Tower 2  
Grand Central Plaza  
138 Shatin Rural Committee  
Road  
Shatin, New Territories  
Hong Kong  
Tel. +852 (0) 237-57382  
Fax +852 (0) 237-57936  
E-mail: [info@geze.com.hk](mailto:info@geze.com.hk)

**GEZE Industries (Tianjin) Co., Ltd.**

Shuangchenzhong Road  
Beichen Economic Development  
Area (BEDA)  
Tianjin 300400, P.R. China  
Tel. +86 (0) 22-26973995-0  
Fax +86 (0) 22-26972702  
E-mail: [geze@public1.tpt.tj.cn](mailto:geze@public1.tpt.tj.cn)

**GEZE Industries (Tianjin) Co., Ltd.**

Branch Office Shanghai  
Dynasty Business Center  
Room 401-402  
No. 457 WuRuMuQi North Road  
200040 Shanghai, P.R. China  
Tel. +86-(0)21-52 34 09-60/-61/-62  
Fax +86-(0)21-52 34 09-63  
E-mail: [gezesh@geze.com.cn](mailto:gezesh@geze.com.cn)

**GEZE Industries (Tianjin) Co., Ltd.**

Branch Office Guangzhou  
Room 1113, Jie Tai Plaza  
218-222 Zhong Shan Liu Road  
510180 Guangzhou  
P.R. China  
Tel. +86 (0) 20-813207-02  
Fax +86 (0) 20-813207-05  
E-mail: [gezegz@public2.sta.net.cn](mailto:gezegz@public2.sta.net.cn)

**GEZE Industries (Tianjin) Co., Ltd.**

Branch Office Beijing  
The Grand Pacific Building  
B Tower Room 201  
8 A, Guanghua Road  
Chaoyang District  
100026 Beijing, P.R. China  
Tel. +86-(0)10-65 81 57-32/-42/-43  
Fax +86-(0)10-65 81 57 33  
E-mail: [gezebj@geze.com.cn](mailto:gezebj@geze.com.cn)

**GEZE Asia Sales Ltd.**

No. 88-1-408, East Road  
Free Trade Zone of Tianjin Port  
Tianjin, P.R. China  
Tel. +86 (0)22-26 97 39 95-0  
Fax +86 (0)22 26 97 27 02  
E-mail: [geze@public1.tpt.tj.cn](mailto:geze@public1.tpt.tj.cn)